

ADDENDUM NO. 1

TO CONSTRUCT

**KAUIKEAOULI HALE
KAUIKEAOULI HALE – 10th & 11th Floor – Paint and Carpet
1111 ALAKEA STREET
HONOLULU, HAWAI'I 96813
TAX MAP KEY: 2-1-017:003
PROJECT IDENTIFIER: JUD-OPM 23-2-0300**

FOR THE JUDICIARY
STATE OF HAWAI'I

/s/ Rodney A. Maile

RODNEY A. MAILE
ADMINISTRATIVE DIRECTOR OF THE COURTS
THE JUDICIARY - STATE OF HAWAI'I

MARCH 2024

This addendum modifies the original Solicitation Documents for the Project dated March 2024 and any previously issued addenda. The items in this addendum shall govern the work, taking precedence over previously issued specifications and drawings governing the items mentioned. Acknowledge receipt of this Addendum in the space provided on the Solicitation, Offer and Contract Form.

ADDENDUM NO. 001

DATE ISSUED: March 18, 2024

1. Attaching Kauikeaouli Hale 10th and 11th Floor Renovation Drawings.

END OF ADDENDUM NO. 1

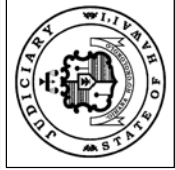

The Judiciary
State of Hawaii
777 Punchbowl St.
Honolulu, HI 96813

CONSTRUCTION ENTRY

10TH AND 11TH FLOOR HALLWAY RENOVATION
T.M.K. 2-1-017: 003
KAUIKEAOULI HALE, 1111 ALAKEA STREET, HONOLULU, HAWAII, 96813

PROJOPM 23-2-0300
PHASE: BID DOCS
DATE: FEB. 2024
DWG NO:

SHEET: 1 OF 3
DWG SIZE: 11"x17"

CONSTRUCTION ENTRY NOTES:
MOVEMENT OF PERSONNEL, EQUIPMENT AND MATERIALS FROM THE LOADING DOCK TO THE WORK SITE (ON 10TH & 11TH FLOORS) IS VIA ELEVATOR #2 LOCATED AT THE MAUKA END OF THE BUILDING AND APPROXIMATELY 30 FEET FROM THE DOCK AND WORK AREAS. ELEVATOR DIMENSIONS ARE: 9'-0"H X 6'-9"W X 6'-0"D

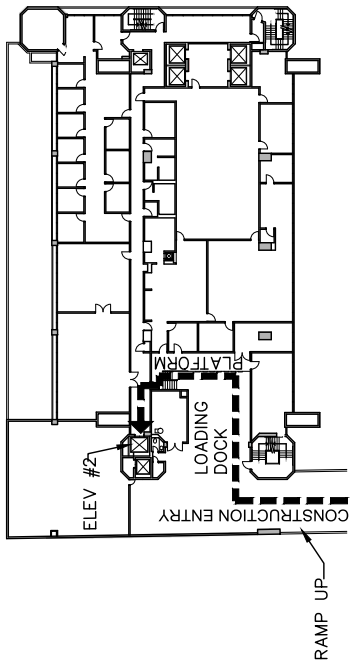
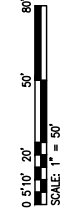

1 FIRST FLOOR PLAN
Scale: 1" = 50' (ABOVE PLAZA LEVEL)

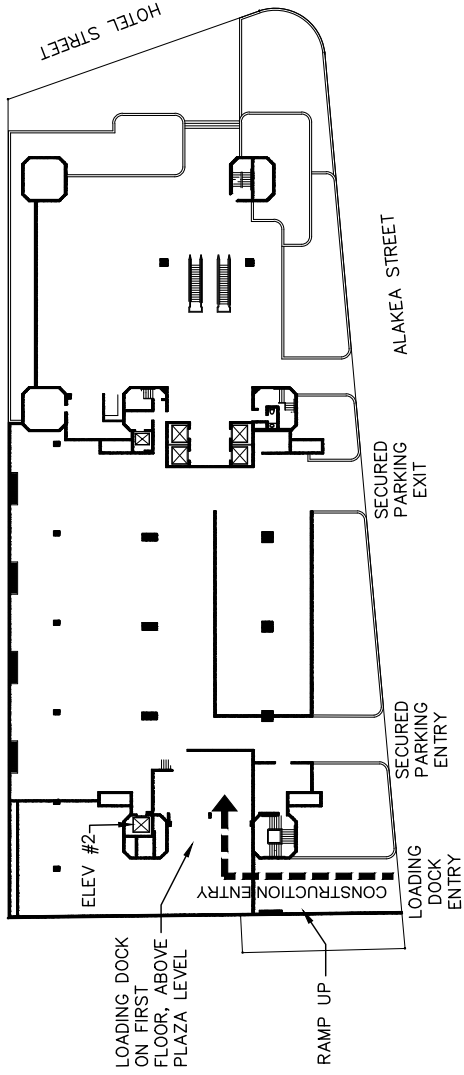

2 PLAZA LEVEL PLAN
Scale: 1" = 50' (BELOW FIRST FLOOR)

KAUIKEAOULI HALE (DISTRICT COURT) 11th FLOOR

HATCHED AREA= AREA OF FLOOR COVERING

HATCHED AREA PERIMETER= LINEAR FOOTAGE OF WALLS AT 9' HIGH

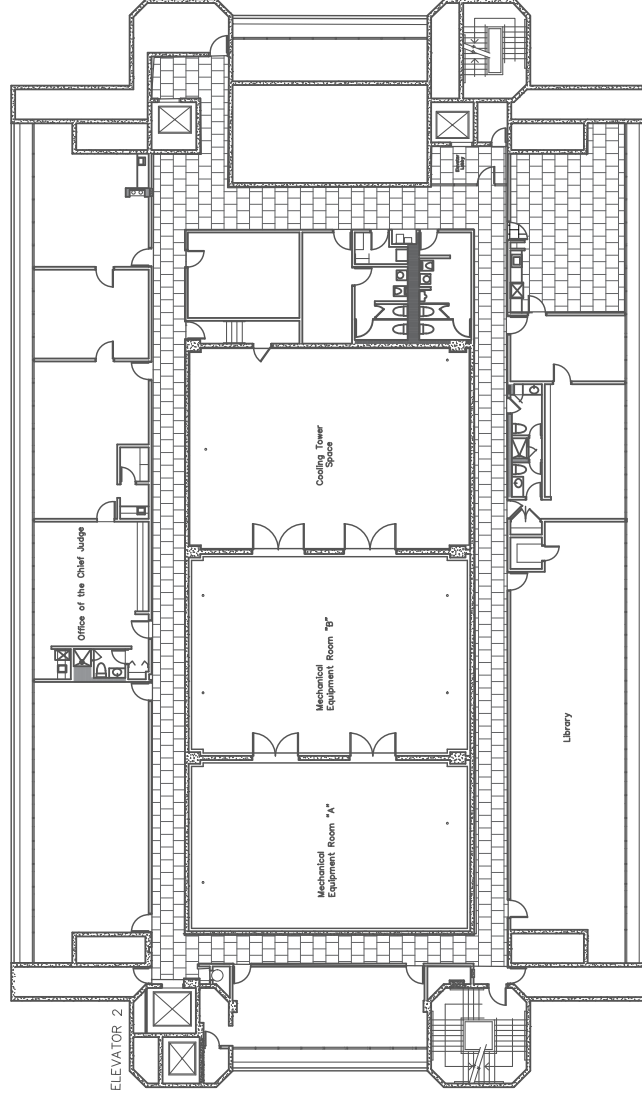

GRAPHIC SCALE



General Notes

| No. | Revision/Issue | Date |
|-----|----------------|------|
| | | |

1111 Alakea Street, Honolulu, Hawaii 96813

Project Name and Address
 Kauikoaouli Hale Architectural
 Drawings
 1111 Alakea Street
 Honolulu, Hawaii 96813
 Fax Map Key: 2-1-017003

| | |
|------------------------------------|-------------|
| 11th Floor Footings Bidder Copy | SHEET 2 |
| February 1, 2024 | OF 3 SHEETS |
| Scale as Shown | |

KAUIKEAOULI HALE (DISTRICT COURT) 10th FLOOR

HATCHED AREA= AREA OF FLOOR COVERING

HATCHED AREA PERIMETER= LINEAR FOOTAGE OF WALLS AT 9' HIGH

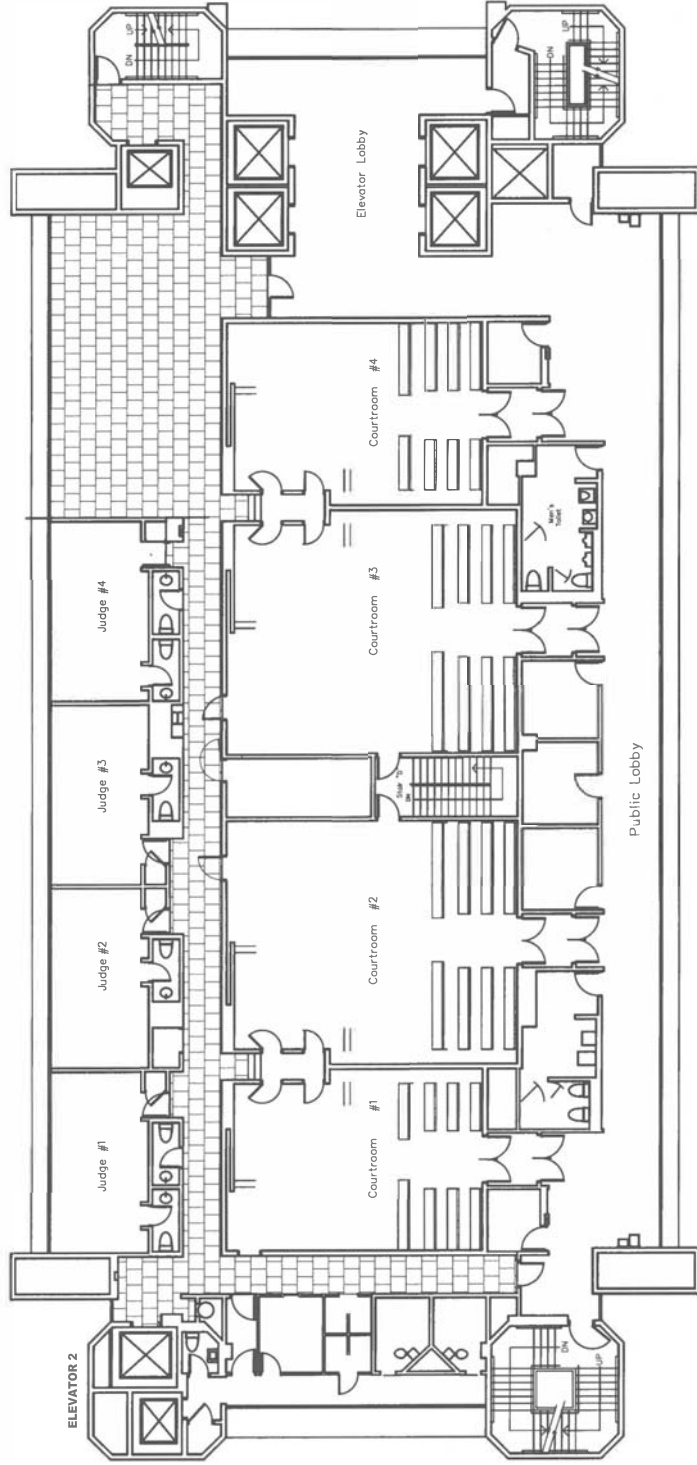

General Notes

| No. | Revision/Issue | Date |
|-----|----------------|------|
| | | |

1111 Alakea Street, Honolulu, Hawaii 96813

Project Name and Address
 Kauikoaouli Hale Architectural
 1111 Alakea Street
 Honolulu, Hawaii 96813
 Tax. Map Key: 2-1-017.003

| | |
|--|------------|
| 1000 Series Drawings Building Plans | SHEET 3 |
| February 1, 2024 | |
| Scale as Shown | |